

This garden is a concept design for Canberras National Arboretum. It would be an addition to their gallery of gardens, which currently holds 6 other sites. This includes an aids reflection garden, a labyrinth a native Australian garden and more. Limitations to the garden design where that it must have an overall theme and must consider all surroundings, such as wind and sun directions, existing views, traffic conditions and more.

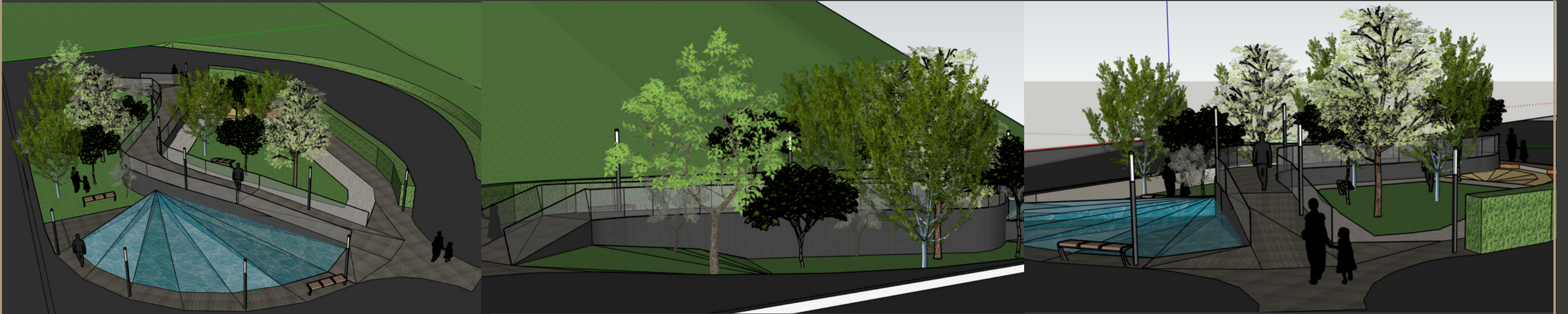

EARTH REFLECTION GARDEN

The Earth Reflection Garden is an appreciation garden for the nature which surrounds us daily. In our busy lives, we humans tend to forget to take a look around and appreciate the beauty of mother nature. So, this garden provides a space for visitors to do exactly that. All features incorporated either resemble a connection to nature, or are for nature viewing purposes. A large variance of tree and plant types have been used to represent all environments globally, but will also attract a wide range of birds and other wildlife to enter the garden. To view these special visitors in the best possible way, a risen pathway is seen to travel throughout the centre of the garden. Not only does this path provide a good view into the tree tops, it is practical for bypassing travellers to get through and still see all elements of the garden. Other main features include a sand pit for children to play in which has connection to desert environments, a water element, and general grass areas to lay upon.

